

## SUMMARY

### # Wires

|         |    |
|---------|----|
| Low     | 19 |
| High    | 0  |
| Coax    | 0  |
| Triax   | 0  |
| Quad    | 0  |
| Fiber   | 0  |
| Fluidic | 0  |

|                  |                 |
|------------------|-----------------|
| Series           | 2M              |
| Termination type | Male crimp      |
| IP rating        | 68              |
| Cable Ø          | 6.50 - 13.00 mm |
| Matching parts   | EGN.2M.319.XLM  |



### Download

[Request a quote](#)

[Catalog](#)

## TECHNICAL DETAILS

### Mechanics

|                   |   |
|-------------------|---|
| Shell Style/Model | FG*: Straight plug with arctic grip   |
| Keying            | 3 keys (beta=165, gamma=30, plug: male contacts, receptacle: female contacts)                             |
| Housing Material  | Environment friendly aluminium (nickel plated, anthracite color) shell and nut, other pieces bronze/brass |
| Cable Fixing      | ∅ 6.5 - 13 mm   |
| Variant           |   |

### Performance

|               |                         |
|---------------|-------------------------|
| Configuration | 2M.319 : 19 Low Voltage |
| Insulator     |                         |
| Rated Current | 5 Amps                  |

### Specifications

|                    |                               |
|--------------------|-------------------------------|
| Contact Type:      | Crimp                         |
| Max. Matings:      | 5000                          |
| Contact Retention: | 22 N                          |
| Contact Dia.:      | 0.7 mm (0.028in)              |
| Bucket Dia.:       | 0.8 mm (0.031in)              |
| Min. Conductor:    | 0.14 mm <sup>2</sup> (AWG 26) |
| Max. Conductor:    | 0.34 mm <sup>2</sup> (AWG 22) |

R (max): 6.1 mOhm  
 Test voltage (kV rms) Contact-contact: 1.55  
 Test voltage (kV rms) Contact-shell: 0.95

## Others

Humidity (max): <=95% [at 60 deg C / 140 F]  
 Vibration: 15 g [10 Hz - 2000 Hz]  
 Shock Resistance: 100 g [ 6 ms]  
 Operating temperature: -55°C / +200°C  
 Climatical Category: 15/200/21 (Al. shell)  
 Lighting strike EIA 364-75 10K amps - 6 times  
 EMI Shielding EIA 364-66A - 1Ghz-80 dB, 3GHz-70 dB, 6GHz- 58dB  
 IP Rating: 68

# DRAWINGS

## Draws

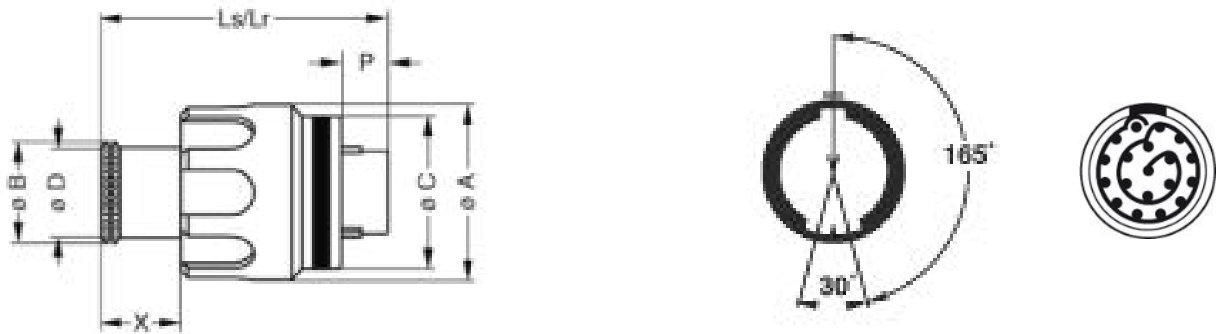

## Dimensions





|     | A    | B    | C    | D    | Lr   | Ls   | P    | X    |
|-----|------|------|------|------|------|------|------|------|
| mm. | 18.9 | 14   | 17.2 | 13   | 24.5 | 24.5 | 3.9  | 7.1  |
| in. | 0,74 | 0,55 | 0,68 | 0,51 | 0,96 | 0,96 | 0,15 | 0,28 |

# RECOMMENDED BY LEMO

## Tools

Crimp Tool: DPC.91.701.V  
 Crimp settings: AWG/Selector = 22-24-26/6-5-5  
 Positionner: DCE.91.070.5MVC  
 Extractor: DCF.93.070.4LT  
 Replacement contact: FGN.0M.555.ZZC

## Cables

|                    |               |       |   |
|--------------------|---------------|-------|---|
| CMN.19.T22.079QGZE | TPR (medical) | Grey  |  |
| CMN.19.T22.080PGCE | PVC           | GREY  |   |
| CMN.19.T22.080PGZE |               | Grey  |  |
| CMN.19.T22.080PNCE | PVC           | Black |   |
| CMN.19.T22.080PNZE |               |       |  |