



EGN.2M.319.XLM

MECHANICAL DETAILS

Shell Style Model EG* : Fixed receptacle nut fixing

Keying 3 keys (beta=165, gamma=30, plug: male contacts, receptacle: female contacts)

Housing Material Environment friendly aluminium (nickel plated, anthracite color) shell and nut, other pieces bronze/brass

Cable Fixing 0 - 0 mm

Variant 2 :

	C	D	E	L	P	S1	e
Mm.	17.2	6.8	4.5	18.1	5.3	12.5	M14x1.0
In.	0.68	0.27	0.18	0.71	0.21	0.49	

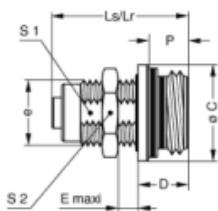

PERFORMANCE DETAIL

Insert 2M.319 : 19 Low Voltage

Insulator

Specifications

Contact Type: Crimp

Max. Matings: 5000

Contact 22 N

Contact Dia.: 0.7 mm (0.028in)

Bucket Dia.: 0.8 mm (0.031in)

Min. Conductor: 0.14 mm² (AWG 26)

Max. Conductor: 0.34 mm² (AWG 22)

R (max): 6.1 mOhm

Extractor: DCF.93.070.4LT

Positioner: DCE.91.070.3MM



OTHER CHARACTERISTICS

Shell Style/Model Libellé

Humidity (max): <=95% [at 60 deg C /140 F]

Vibration: 15 g [10 Hz - 2000 Hz]

Shock Resistance: 100 g [6 ms]

Operating -55°C / +200°C

Climatical 15/200/21 (Al. shell)

Lighting strike EIA 10K amps - 6 times

EMI Shielding EIA - 1Ghz-80 dB,3GHz-70 dB,6GHz- 58dB

IP Rating 68

