

Montagecode
Z91
assembly code

Panel Piercing Montageausschnitt

Montagecode
Z91
assembly code

empfohlene Lötflächen
recommended solder areas

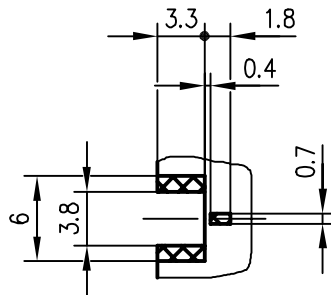

Index <i>index</i>	Änderung <i>modification</i>	Datum <i>date</i>	Name <i>name</i>

Original <i>original</i>	A4	Blatt <i>sheet</i>	1/1
-----------------------------	----	-----------------------	-----

	Datum <i>date</i>	Name <i>name</i>
Gez. <i>drawn</i>	12.04.99	BA
Gepr. <i>app'd</i>	24.06.99	KL

Maßstab <i>scale</i>	2:1
-------------------------	-----

Recommended solder areas
Empfohlene Lötflächen

Unteri.- Art	TG-Nr.
R	T00100Z0091

Ersatz für/*replacement for*

