



FGS.1M.307.XLMT

MECHANICAL DETAILS

Shell Style Model FG* : Straight plug with arctic grip and mold stop

Keying 3 keys (beta=155, gamma=50, plug: female contacts, receptacle: male contacts)

Housing Material Environment friendly aluminium (nickel plated, anthracite color) shell and nut, other pieces bronze/brass

Cable Fixing 0 - 0 mm

Variant 2 :

				A	B	C	D	F
Mm.				15.9	10.5	14.2	9.7	12.4
In.				0.63	0.41	0.56	0.38	0.49

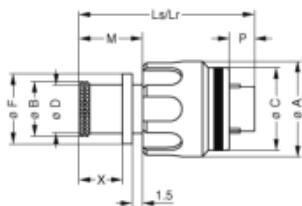

PERFORMANCE DETAIL

Insert 1M.307 : 7 Low Voltage

Insulator

Specifications

Contact Type: Crimp

Max. Matings: 5000

Contact 22 N

Contact Dia.: 0.7 mm (0.028in)

Bucket Dia.: 0.8 mm (0.031in)

Min. Conductor: 0.14 mm² (AWG 26)

Max. Conductor: 0.34 mm² (AWG 22)

R (max): 6.1 mOhm

Extractor: DCF.93.070.4LT

Positioner: DCE.91.070.3MM

OTHER CHARACTERISTICS

Shell Style/Model Libellé

Humidity (max): <=95% [at 60 deg C /140 F]

Vibration: 15 g [10 Hz - 2000 Hz]

Shock Resistance: 100 g [6 ms]

Operating -55°C / +200°C

Climatical 15/200/21 (Al. shell)

Lighting strike EIA 10K amps - 6 times

EMI Shielding EIA - 1Ghz-80 dB,3GHz-70 dB,6GHz- 58dB

IP Rating 68

