

MECHANICAL DETAILS

Shell Style Model	EG* : Fixed receptacle nut fixing
Keying	3 keys (beta=155, gamma=50, plug: female contacts, receptacle: male contacts)
Housing Material	Environment friendly aluminium (nickel plated, anthracite color) shell and nut, other pieces bronze/brass
Cable Fixing	0 - 0 mm

Variant 2 :

	C	D	E	L	P	S1	e
Mm.	14.2	6.8	4.5	18.1	5.3	9.5	M11x1.0
In.	0.56	0.27	0.18	0.71	0.21	0.37	

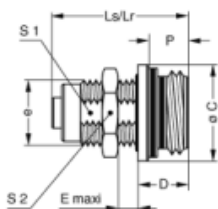

PERFORMANCE DETAIL

Insert	1M.308 : 8 Low Voltage
Insulator	
Specifications	
Contact Type:	Crimp
Max. Matings:	5000
Contact	22 N
Contact Dia.:	0.7 mm (0.028in)
Bucket Dia.:	0.8 mm (0.031in)
Min. Conductor:	0.14 mm ² (AWG 26)
Max. Conductor:	0.34 mm ² (AWG 22)
R (max):	6.1 mOhm
Extractor:	DCF.93.070.4LT
Positioner:	DCE.91.070.5MVC



OTHER CHARACTERISTICS

Shell Style/Model	Libellé
Humidity (max):	<=95% [at 60 deg C /140 F]
Vibration:	15 g [10 Hz - 2000 Hz]
Shock Resistance:	100 g [6 ms]
Operating	-55°C / +200°C
Climatical	15/200/21 (Al. shell)
Lighting strike EIA	10K amps - 6 times
EMI Shielding EIA	- 1Ghz-80 dB,3GHz-70 dB,6GHz- 58dB
IP Rating	68

